



Home Interiors

www.supp-ly.com

📞 799 666 0010

About us

ULI an initiative from supp-ly.com, bringing together good design, craftsmanship, and technology.

The founding team have decades of experience in the real estate industry, which includes design and build of custom-made homes with a renowned architectural firm.

With the backing of our in-house materials and services platform [www.supp-ly.com] , we provide access to curated brands, products and craftsmanship which culminates to good design and craftsmanship.

ULI stands for reliability, skill and craftsmanship- so are we!!!

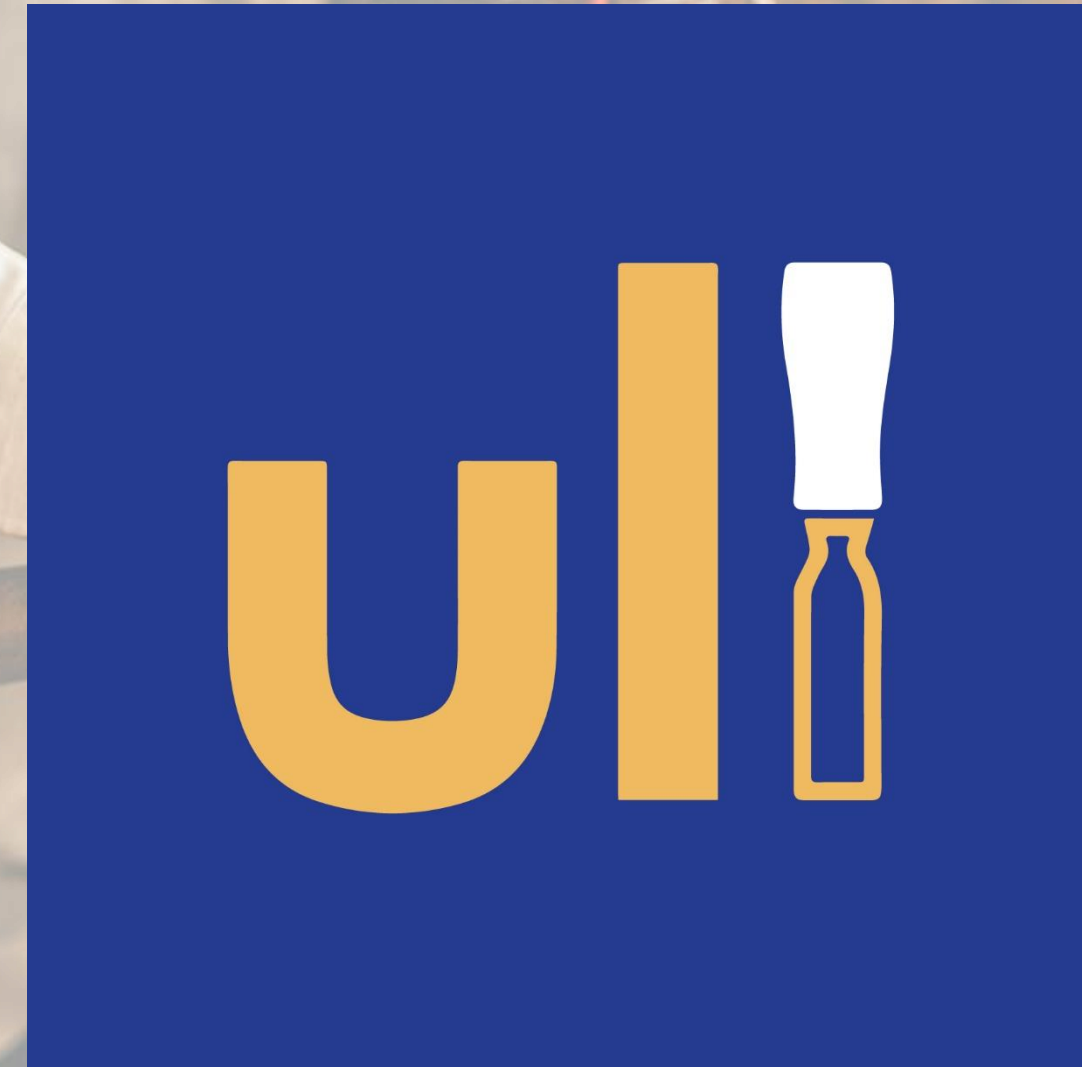

We supply design.

We will sit with you and understand your likes and produce designs to craft your home interiors. This is your home. We're the facilitators.

In our home interiors, the textures, colors, and finishes come together in perfect harmony, creating a space that not only appeals to the senses but also reflects the personality and style of its inhabitants. It's a sanctuary where every detail has been considered, resulting in a living masterpiece that transcends trends and stands the test of time.

Supp-ly.com provides product standardization and transparency in all aspects. We have 20000+ SKUs (Stock Keeping Units, unique items) under a single "roof". We're big on quantity and quality.

We believe that every individual's vision is distinct, and so we offer a palette of choices as diverse as your imagination. Our platform offers options based on material choices and budget, along with the flexibility to build with or without materials.

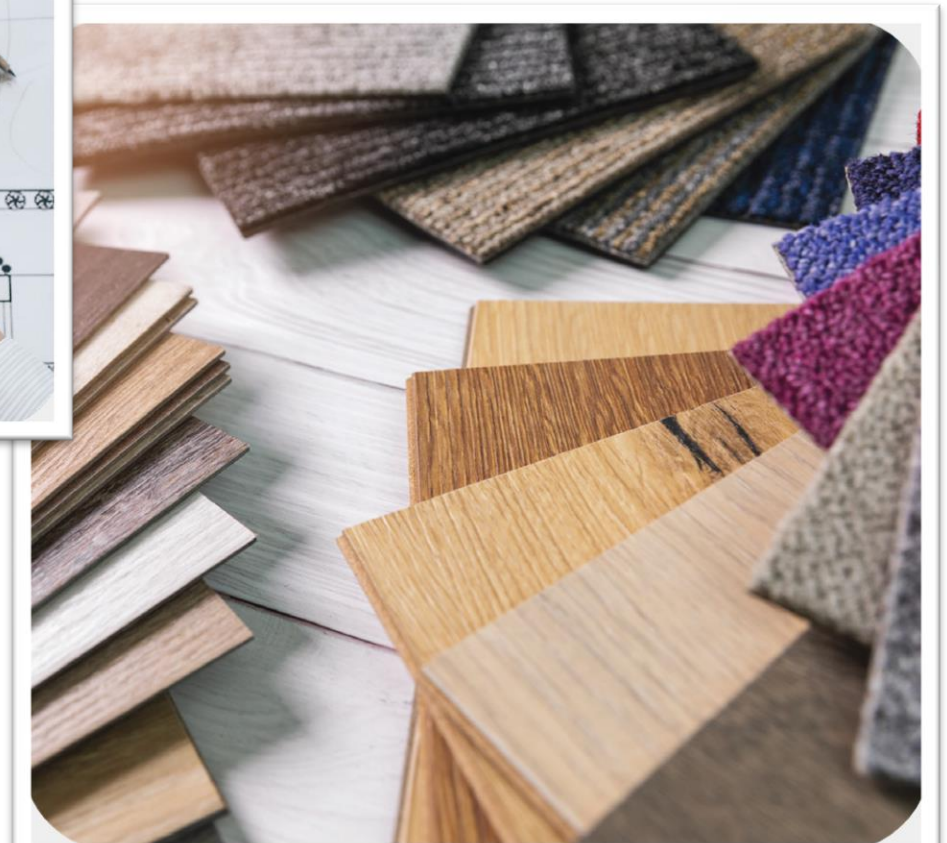
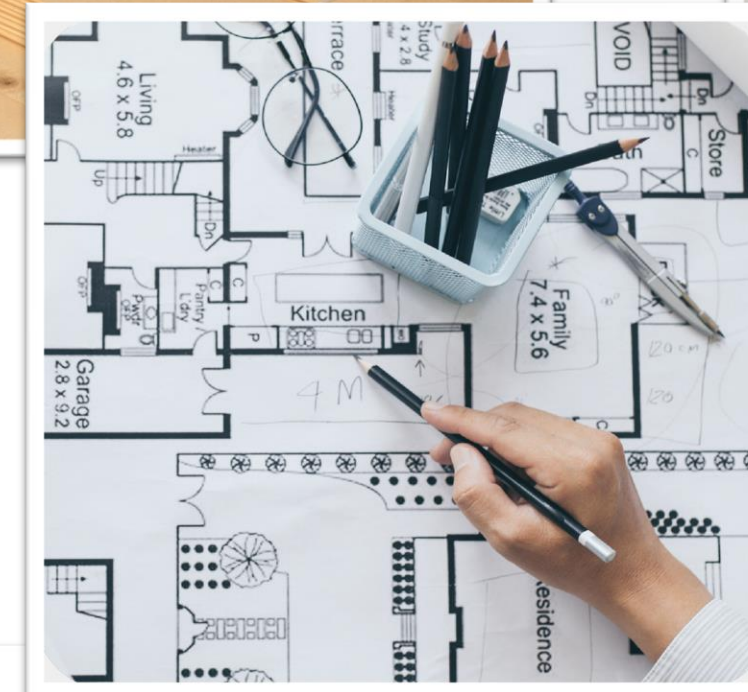
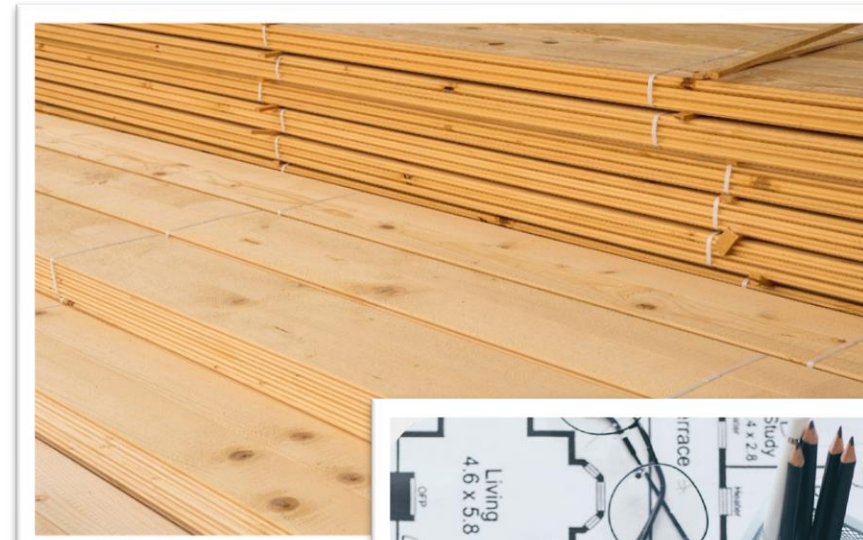



We supply craftsmanship.

Craftsmanship is the heartbeat of your home's creation, where skilled hands transform raw materials into works of art. We understand that every nail, every joint, and every connection matters. That's why we meticulously handpick the finest masons, carpenters, plumbers and electricians.

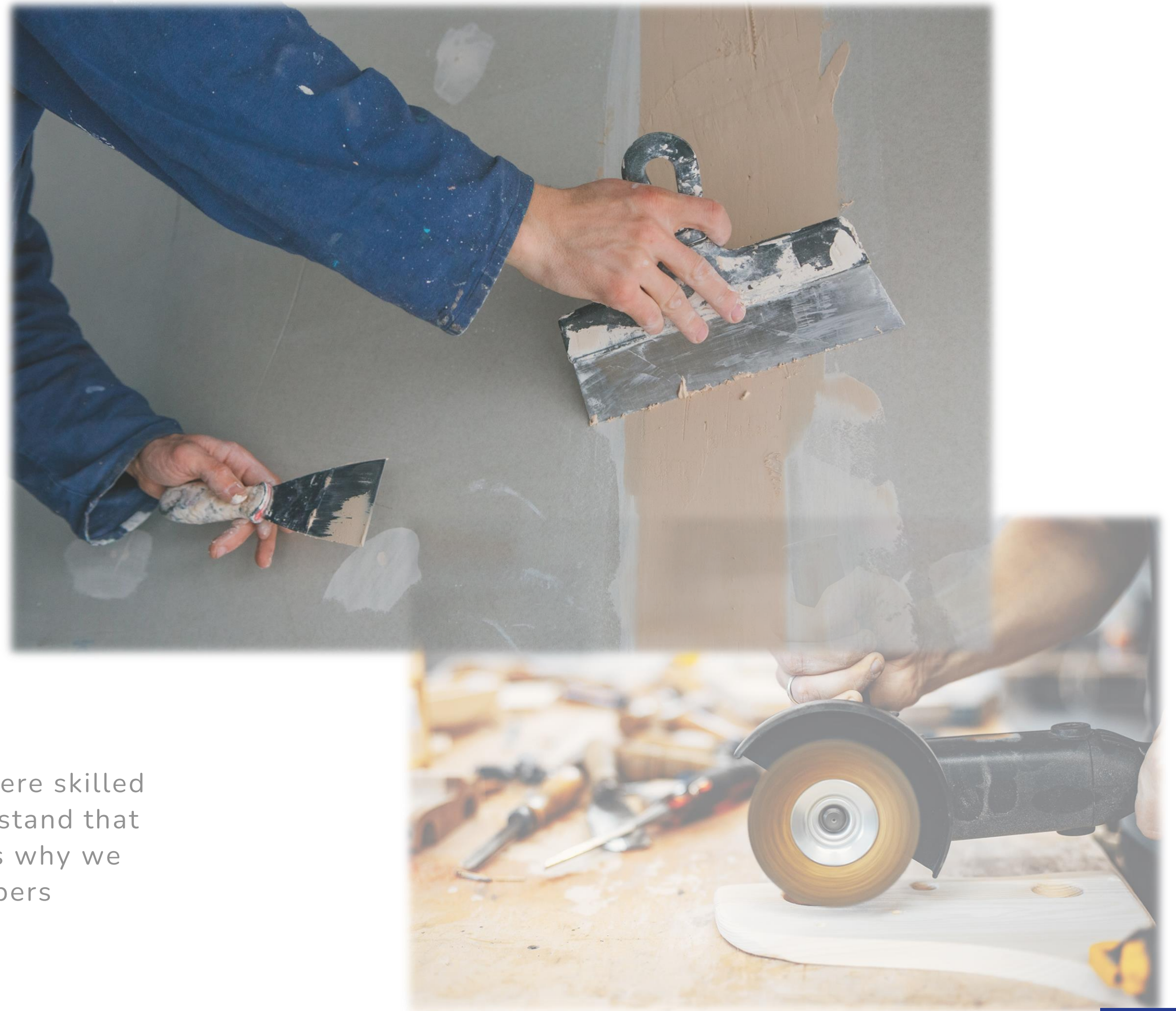



and many more!

We supply trust, reliability

Trust forms the cornerstone of our approach to building your dream home. Our commitment to trust underpins every vendor selection. We curate a network of partners who share our values, ensuring that each vendor is not just a provider, but a collaborator invested in your vision.



We supply your home. **We supply love.**

Your dream home isn't just a structure; it's a sanctuary where memories are born, laughter resonates, and life unfolds. Our commitment is not just to supply a house, but a haven filled with the warmth and love that make it uniquely yours.



We supply care.

Our partnership extends far beyond the final nail and finishing touch. Just as we've been with you throughout the creation of your dream home, we remain steadfast in ensuring its lasting beauty and functionality. We're here to keep your house in good shape and maintain it.

We supply options.

Essentials

- Ply + Laminate Wardrobes in Bedrooms
- Modular Kitchen with basic accessories
- TV Unit
- Shoe Rack
- Undercounter closet in bathrooms
- Lighting

Rs 8.5 Lacs

Lifestyle

- Essentials +
- Pooja Unit
- Dresser
- Crockery Unit
- Study in Bedroom
- Beds
- False Ceiling(Living)
- Ledges
- Shower Partition
- AC in Bedrooms
- Basic Home automation
- Hob and Chimney

Rs 16 Lacs

Lifestyle Plus

- Lifestyle +
- Loose Furniture
- Soft furnishing and Mattresses
- Full Home Automation
- Full Home Acs
- Laminate Wooden Flooring

Rs 30 Lacs

Prices are subject to variation, in case of – (a)Actual site condition. (b)Customization during design discussion. (c)Major civil changes and demolitions or major renovation works. (d)Upgrade on brands or specifications. (e)Increase in sizes of the wardrobes and storage units.

EXECUTION ROADMAP

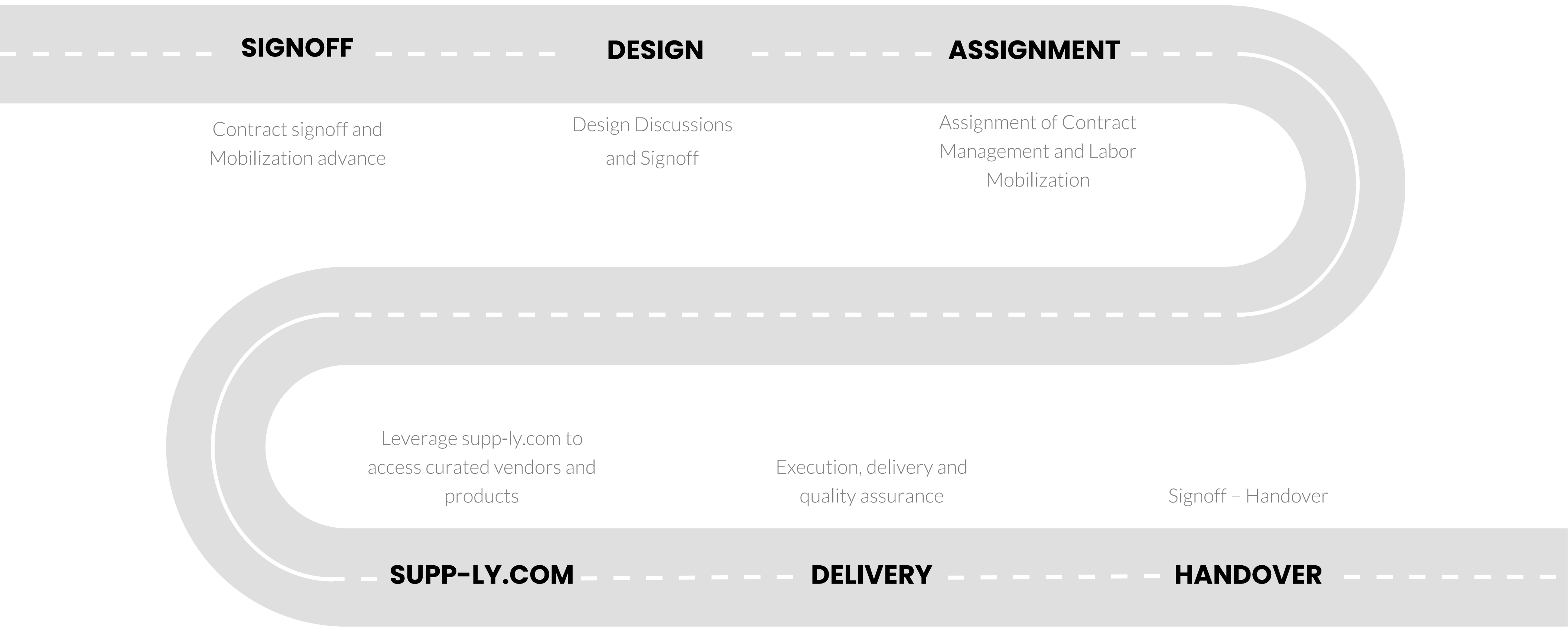

Our WORKs...

Relaxation

Conversation

Entertainment

Television

Family

Decor

LIVING









Bed

Bedside tables

Dressers

Wardrobes

Reading

Rest

Bedroom











Countertops

Cabinets

Preparations

Social

Appliances

Rest

KITCHEN





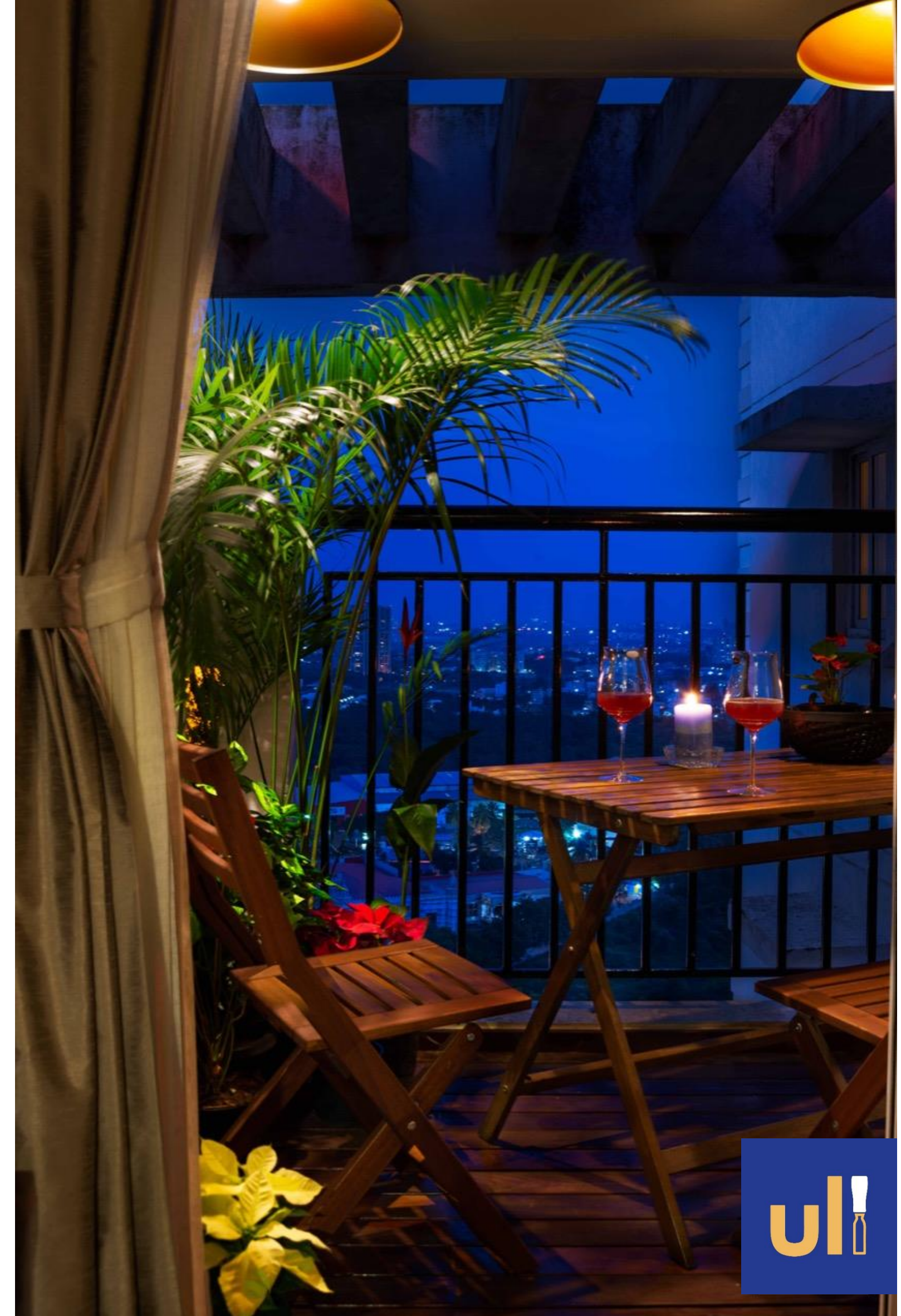



Core Team...



Narayana
Founding Member

Narayana is an Electrical Engineer turned supply chain professional with 28+ years of experience in all facets of Supply Chain covering industry sectors like Mining, Steel, Power and Real Estate. In his last assignment with Total Environment Building Systems Pvt Ltd, he played the role of Group Head, Supply Chain function involving Direct and Indirect procurement. Practitioner of fact-based negotiation involved in over INR 20000 Crores spend during his tenure.



Arun Natarajan
Director Technology

Arun graduated from PSG College of Technology with a Bachelors in Production Engineering, completed a Masters in Information Sciences from LSU, and achieved an MBA from Johns Hopkins University. As a lifelong learner, technologist, and entrepreneur, Arun brings over 28 years of expertise in enterprise architecture, supply-chain management, and solutions engineering. Beyond work, Arun's interests include art and sports. Once an active participant, now Arun cheers for his children in speedskating and archery from the sidelines.



Aditi
Principal Architect

16+ years in the commercial and residential interiors. Handling senior management position and was handling design responsibilities in Gherzi Eastern, FRDC and TE Homes



Rajeshwari
Founding Member

16 + years experience in Procurement including 7 years of experience in handling Procurement for interiors in her last assignment at TE Homes



Ranjitha
Founding Member

12 + years experience in Procurement and contracts in real estate including 3 years of experience in civil contracts in her last assignment at TE Homes



Akarsha
Founding Member

an Engineer, with passion, through his sense of detailing, drives the product curation and the catalogue management.



Vijay Raj
Founding Member

5+ years experience in various facets of construction, has been involved in development of the platform supply.com and played a key role in Customer relationship and new customer acquisition.

THANK YOU!

 799 666 0010